



**Schäfer + Peters GmbH**  
Competence in Stainless Steel



**SICHERHEITSSCHRAUBEN & MUTTERN**  
SECURITY SCREWS & NUTS





**Schäfer + Peters GmbH**  
Zeilbaumweg 32  
DE-74613 Öhringen

Tel. +49 (0) 7941 6094-0  
Fax +49 (0) 7941 6094-700

[info@schaefer-peters.com](mailto:info@schaefer-peters.com)  
[www.schaefer-peters.com](http://www.schaefer-peters.com)



# INHALT

---

SEITE 4	ZWEILOCHANTRIEB
SEITE 9	INNENSECHSKANT + PIN
SEITE 14	INNENSECHSRUND + PIN
SEITE 20	EINWEG-ANTRIEB
SEITE 23	MIT STOPFEN
SEITE 26	ABREISSMUTTER & ABREISSSCHRAUBE

# CONTENT

---

PAGE 4	TWO-HOLE DRIVE
PAGE 9	HEX-SOCKET DRIVE + PIN
PAGE 14	SIX-LOBE DRIVE + PIN
PAGE 20	ONE-WAY DRIVE
PAGE 23	WITH PLUG
PAGE 26	INVIOLENT NUTS & SHEAR SCREWS WITH BRAKING POINT

# ZWEILOCHANTRIEB

## ARTIKEL 9100 - 9109

---

*TWO HOLE DRIVE*  
*ITEM 9100 - 9109*



**PRODUKTVORTEILE:**

- Sicherheitsaufnahme 2 - Loch
- nur mit speziellen Bit zu verarbeiten

**PRODUCT BENEFITS:**

- Security admission 2 - hole
- to process only with special bit

# ARTIKEL 9100 A2 ZYLINDERKOPF-SI SCHRAUBEN, ZWEILOCHANTRIEB, BLECHGEWINDE

ITEM 9100 A2  
CHEESE HEAD SECURITY SCREWS WITH TWO HOLE DRIVE

## MERKMALE:

- Blechgewinde
- Zweilochantrieb
- Zylinderkopf

## FEATURES:

- Sheet thread
- two hole drive
- Cheese head

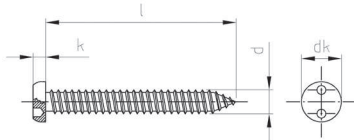

d	2,9	3,5	4,2	4,8	5,5	6,3
<b>l/mm</b>	Art. Nr. / Item no.	Art. Nr. / Item no.	Art. Nr. / Item no.	Art. Nr. / Item no.	Art. Nr. / Item no.	Art. Nr. / Item no.
<b>6,5</b>	9100229 65	9100235 65				
<b>9,5</b>	9100229 95	9100235 95	9100242 95	9100248 95		
<b>13</b>	9100229 13	9100235 13	9100242 13	9100248 13	9100255 13	9100263 13
<b>16</b>	9100229 16	9100235 16	9100242 16	9100248 16	9100255 16	9100263 16
<b>19</b>	9100229 19	9100235 19	9100242 19	9100248 19	9100255 19	9100263 19
<b>25</b>	9100229 25	9100235 25	9100242 25	9100248 25	9100255 25	9100263 25
<b>32</b>		9100235 32	9100242 32	9100248 32	9100255 32	9100263 32
<b>38</b>		9100235 38	9100242 38	9100248 38	9100255 38	9100263 38
<b>45</b>		9100235 45	9100242 45	9100248 45	9100255 45	9100263 45
<b>50</b>		9100235 50	9100242 50	9100248 50	9100255 50	9100263 50

<b>l</b>	100	100	100	100	100	100
<b>dk</b>	5,6	5,7	7,6	9,5	10,5	10,5
<b>k</b>	1,65	1,65	2,2	2,75	3,3	3,3
<b>Antrieb</b>	SP-4	SP-6	SP-8	SP-10	SP-12	SP-1/4

# ARTIKEL 9101 A2 ZYLINDERKOPF-SI SCHRAUBEN, ZWEI- LOCHANTRIEB, METRISCHES GEWINDE

ITEM 9101 A2  
CHEESE HEAD SECURITY SCREWS WITH TWO HOLE DRIVE

## MERKMALE:

- Metrisches Gewinde
- Zweilochantrieb
- Zylinderkopf

## FEATURES:

- Metric thread
- two hole drive
- Cheese head

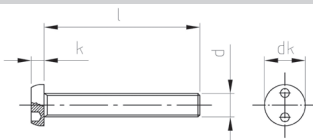

d	M 3	M 3,5	M 4	M 5	M 6
<b>l/mm</b>	Art. Nr. / Item no.	Art. Nr. / Item no.	Art. Nr. / Item no.	Art. Nr. / Item no.	Art. Nr. / Item no.
<b>6</b>	910123 6	9101235 6	910124 6		
<b>8</b>	910123 8		910124 8		
<b>10</b>	910123 10		910124 10	910125 10	910126 10
<b>12</b>	910123 12		910124 12	910125 12	910126 12
<b>16</b>	910123 16		910124 16	910125 16	910126 16
<b>20</b>	910123 20		910124 20	910125 20	910126 20
<b>25</b>			910124 25	910125 25	910126 25
<b>30</b>				910125 30	910126 30
<b>40</b>					910126 40

<b>l</b>	100	100	100	100	100
<b>dk</b>	5,7	6,6	7,6	9,5	10,5
<b>k</b>	1,65	1,9	2,2	2,75	3,3
<b>Antrieb</b>	SP-4	SP-6	SP-8	SP-10	SP-1/4



## ARTIKEL 9102 A2 SENKKOPF-SI SCHRAUBEN, ZWEILOCHANTRIEB, BLECHGEWINDE

ITEM 9102 A2  
COUNTERSUNK HEAD SECURITY SCREWS TWO HOLE DRIVE

### MERKMALE:

- Blechgewinde
- Zweilochantrieb
- Senkkopf

### FEATURES:

- Sheet thread
- two hole drive
- Countersunk head

d	2,9	3,5	4,2	4,8	5,5	6,3
<b>l/mm</b>	Art. Nr. / Item no.	Art. Nr. / Item no.	Art. Nr. / Item no.	Art. Nr. / Item no.	Art. Nr. / Item no.	Art. Nr. / Item no.
<b>6,5</b>	9102229 65					
<b>9,5</b>	9102229 95	9102235 95	9102242 95			
<b>13</b>	9102229 13	9102235 13	9102242 13	9102248 13	9102255 13	9102263 13
<b>16</b>	9102229 16	9102235 16	9102242 16	9102248 16	9102255 16	9102263 16
<b>19</b>	9102229 19	9102235 19	9102242 19	9102248 19	9102255 19	9102263 19
<b>25</b>	9102229 25	9102235 25	9102242 25	9102248 25	9102255 25	9102263 25
<b>32</b>		9102235 32	9102242 32	9102248 32	9102255 32	9102263 32
<b>38</b>		9102235 38	9102242 38	9102248 38	9102255 38	9102263 38
<b>45</b>		9102235 45	9102242 45	9102248 45	9102255 45	9102263 45
<b>50</b>			9102242 50	9102248 50	9102255 50	9102263 50

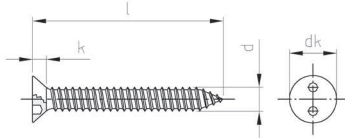

<b>Stück</b>	100	100	100	100	100	100
<b>dk</b>	5,6	6,8	8,1	9,5	10,8	12,4
<b>k</b>	1,7	2,15	2,6	3,15	3,55	4
<b>Antrieb</b>	SP-4	SP-6	SP-8	SP-10	SP-12	SP-1/4



## ARTIKEL 9103 A2 SENKKOPF-SI-SCHRAUBEN, ZWEILOCH- ANTRIEB, METRISCHES GEWINDE

ITEM 9103 A2  
COUNTERSUNK HEAD SECURITY SCREWS TWO HOLE DRIVE

### MERKMALE:

- Metrisches Gewinde
- Zweilochantrieb
- Senkkopf

### FEATURES:

- Metric thread
- two hole drive
- Countersunk head

d	M 3	M 4	M 5	M 6
<b>l/mm</b>	Art. Nr. / Item no.	Art. Nr. / Item no.	Art. Nr. / Item no.	Art. Nr. / Item no.
<b>6</b>	910323 6			
<b>8</b>	910323 8			
<b>10</b>	910323 10	910324 10		
<b>12</b>	910323 12	910324 12	910325 12	910326 12
<b>16</b>	910323 16	910324 16	910325 16	910326 16
<b>20</b>	910323 20	910324 20	910325 20	910326 20
<b>25</b>	910323 25	910324 25	910325 25	910326 25
<b>30</b>	910323 30	910324 30	910325 30	910326 30
<b>35</b>		910324 35	910325 35	910326 35
<b>40</b>		910324 40	910325 40	910326 40
<b>50</b>		910324 50	910325 50	910326 50

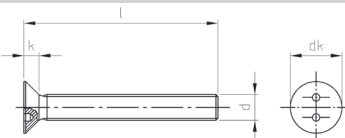

<b>Stück</b>	100	100	100	100
<b>dk</b>	6	8	10	12
<b>k</b>	1,75	2,4	2,95	3,45
<b>Antrieb</b>	SP-4	SP-8	SP-10	SP-1/4



## ARTIKEL 9104 A2 LISEKO-SI SCHRAUBEN, ZWEILOCH- ANTRIEB, BLECHGEWINDE

ITEM 9104 A2  
RAISED CSK HEAD SECURITY SCREWS TWO HOLE DRIVE

### MERKMALE:

- Blechgewinde
- Zweilochantrieb
- Linsenkopf

### FEATURES:

- Sheet thread
- two hole drive
- Raised countersunk head

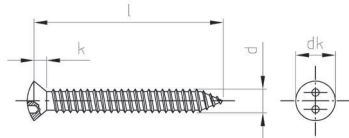

d	3,5	4,2	4,8
<b>l/mm</b>	Art. Nr. / Item no.	Art. Nr. / Item no.	Art. Nr. / Item no.
<b>13</b>	9104235 13	9104242 13	9104248 13
<b>16</b>	9104235 16	9104242 16	9104248 16
<b>19</b>	9104235 19	9104242 19	9104248 19
<b>25</b>	9104235 25	9104242 25	9104248 25
<b>32</b>	9104235 32	9104242 32	9104248 32
<b>38</b>	9104235 38	9104242 38	9104248 38
<b>50</b>	9104235 50	9104242 50	9104248 50
<b>l</b>	100	100	100
<b>dk</b>	5,7	7,6	9,5
<b>k</b>	1,65	2,2	2,75
<b>Antrieb</b>	SP-6	SP-8	SP-10

## ARTIKEL 9105 A2 RUNDKOPF-SI SCHRAUBEN, ZWEILOCH- ANTRIEB, BLECHGEWINDE

ITEM 9105 A2  
PAN HEAD SECURITY SCREWS WITH TWO HOLE DRIVE



### MERKMALE:

- Blechgewinde
- Zweilochantrieb
- Rundkopf

### FEATURES:

- Sheet thread
- two hole drive
- Pan head

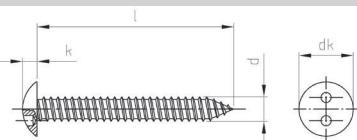

d	4,2	4,8
<b>l/mm</b>	Art. Nr. / Item no.	Art. Nr. / Item no.
<b>9,5</b>	9105242 95	9105248 95
<b>13</b>	9105242 13	9105248 13
<b>19</b>	9105242 19	9105248 19
<b>25</b>	9105242 25	9105248 25
<b>32</b>	9105242 32	9105248 32
<b>38</b>	9105242 38	9105248 38
<b>50</b>	9105242 50	9105248 50
<b>l</b>	100	100
<b>dk</b>	9,5	10,5
<b>k</b>	2,2	2,75
<b>Antrieb</b>	SP-8	SP-10



# ARTIKEL 9109 A2 SI-BITS FÜR ZWEILOCHANTRIEBE

ITEM 9109 A2  
SECURITY BITS FOR TWO HOLE DRIVE

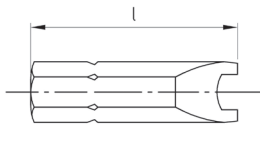
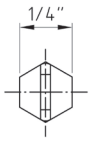

Antrieb Drive size	l l	Artikelnummer Item Number	
SP-1/4	25	910914	1
SP-10	25	910910	1
SP-12	25	910912	1
SP-4	25	91094	1
SP-6	25	91096	1
SP-8	25	91098	1



# INNENSECHSKANT + PIN

## ARTIKEL 9110 - 9119

---

*HEX SOCKET DRIVE + PIN*  
*ITEM 9110 - 9119*



### PRODUKTVORTEILE:

- Sicherheitsaufnahme PIN
- nur mit speziellen Bit zu verarbeiten

### PRODUCT BENEFITS:

- Security admission PIN
- to process only with special bit

# ARTIKEL 9110 A2 FLACHRUNDKOPF-SI SCHRAUBEN, ISK + PIN, BLECHGEWINDE

ITEM 9110 A2  
BUTTON HEAD SECURITY SCREWS HEX SOCKET DRIVE + PIN

## MERKMALE:

- Blechgewinde
- ISK + PIN
- Flachrundkopf

## FEATURES:

- Sheet thread
- ISK + PIN
- Button head

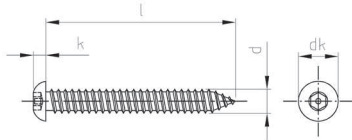

d	3,5	4,2	4,8	6,3
<b>l/mm</b>	Art. Nr. / Item no.	Art. Nr. / Item no.	Art. Nr. / Item no.	Art. Nr. / Item no.
<b>9,5</b>	9110235 95			
<b>13</b>	9110235 13	9110242 13	9110248 13	9110263 13
<b>16</b>	9110235 16	9110242 16	9110248 16	9110263 16
<b>19</b>	9110235 19	9110242 19	9110248 19	9110263 19
<b>25</b>	9110235 25	9110242 25	9110248 25	9110263 25
<b>32</b>	9110235 32	9110242 32	9110248 32	9110263 32
<b>38</b>	9110235 38	9110242 38	9110248 38	9110263 38
<b>50</b>	9110235 50	9110242 50	9110248 50	9110263 50
<b>95</b>		9110242 95		
<b>Ø</b>	100	100	100	100
<b>dk</b>	5,7	7,6	9,5	10,5
<b>k</b>	1,65	2,2	2,75	3,3
<b>Antrieb</b>	SW2 PIN	SW2,5 PIN	SW3 PIN	SW4 PIN

# ARTIKEL 9111 A2 FLACHRUNDKOPF-SI SCHRAUBEN, ISK + PIN, METRISCHES GEWINDE

ITEM 9111 A2  
BUTTON HEAD SECURITY SCREWS HEX SOCKET DRIVE + PIN



#### MERKMALE:

- Metrisches Gewinde
- ISK + PIN
- Flachrundkopf

#### FEATURES:

- Metric thread
- ISK + PIN
- Button head

d	M 3	M 4	M 5	M 6	M 8	M 10
<b>l/mm</b>	Art. Nr. / Item no.	Art. Nr. / Item no.	Art. Nr. / Item no.	Art. Nr. / Item no.	Art. Nr. / Item no.	Art. Nr. / Item no.
6	911123 6	911124 6				
8	911123 8	911124 8				
10	911123 10	911124 10	911125 10	911126 10	911128 10	
12	911123 12	911124 12	911125 12	911126 12	911128 12	
16	911123 16	911124 16	911125 16	911126 16	911128 16	9111210 16
20	911123 20	911124 20	911125 20	911126 20	911128 20	9111210 20
25		911124 25	911125 25	911126 25	911128 25	9111210 25
30		911124 30	911125 30	911126 30	911128 30	9111210 30
40		911124 40	911125 40	911126 40	911128 40	9111210 40
45					911128 45	9111210 45
50			911125 50	911126 50	911128 50	9111210 50
55						9111210 55
60			911125 60	911126 60	911128 60	9111210 60
70						9111210 70
75						9111210 75
80						9111210 80
90						9111210 90

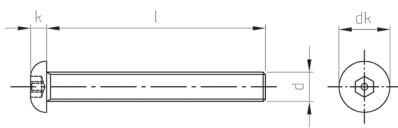

	100	100	100	100	100	100
<b>dk</b>	5,7	7,6	9,5	10,5	14	17,5
<b>k</b>	1,65	2,2	2,75	3,3	4,4	5,5
<b>Antrieb</b>	SW2 PIN	SW2,5 PIN	SW3 PIN	SW4 PIN	SW5 PIN	SW6 PIN

# ARTIKEL 9112 A2 SENKKOPF-SI SCHRAUBEN, ISK + PIN, BLECHGEWINDE

ITEM 9112 A2  
CSK HEAD SECURITY SCREWS HEX SOCKET DRIVE + PIN

### MERKMALE:

- Blechgewinde
- ISK + PIN
- Senkkopf

### FEATURES:

- Sheet thread
- ISK + PIN
- Countersunk head

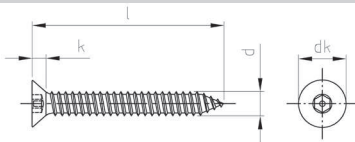

d	3,5	4,2	4,8	5,5	6,3
<b>l/mm</b>	Art. Nr. / Item no.	Art. Nr. / Item no.	Art. Nr. / Item no.	Art. Nr. / Item no.	Art. Nr. / Item no.
<b>9,5</b>	9112235 95				
<b>13</b>	9112235 13	9112242 13	9112248 13	9112255 13	
<b>16</b>	9112235 16	9112242 16	9112248 16	9112255 16	9112263 16
<b>19</b>	9112235 19	9112242 19	9112248 19	9112255 19	9112263 19
<b>25</b>	9112235 25	9112242 25	9112248 25	9112255 25	9112263 25
<b>32</b>	9112235 32	9112242 32	9112248 32	9112255 32	9112263 32
<b>38</b>	9112235 38	9112242 38	9112248 38	9112255 38	9112263 38
<b>50</b>		9112242 50	9112248 50	9112255 50	9112263 50
	100	100	100	100	100
<b>dk</b>	6,8	8,1	9,5	10,8	12,4
<b>k</b>	2,15	2,6	3,15	3,55	4
<b>Antrieb</b>	SW2 PIN	SW2,5 PIN	SW3 PIN	SW4 PIN	SW4 PIN

# ARTIKEL 9113 A2 SENKKOPF-SI SCHRAUBEN, ISK + PIN, METRISCHES GEWINDE

ITEM 9113 A2  
CSK HEAD SECURITY SCREWS HEX SOCKET DRIVE + PIN

### MERKMALE:

- Metrisches Gewinde
- ISK + PIN
- Senkkopf

### FEATURES:

- Metric thread
- ISK + PIN
- Countersunk head

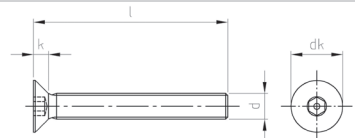

d	M 3	M 4	M 5	M 6	M 8	M 10
<b>l/mm</b>	Art. Nr. / Item no.	Art. Nr. / Item no.	Art. Nr. / Item no.	Art. Nr. / Item no.	Art. Nr. / Item no.	Art. Nr. / Item no.
<b>6</b>	911323 6					
<b>8</b>	911323 8	911324 8	911325 8			
<b>10</b>	911323 10	911324 10	911325 10	911326 10	911328 10	
<b>12</b>	911323 12	911324 12	911325 12	911326 12	911328 12	
<b>16</b>	911323 16	911324 16	911325 16	911326 16	911328 16	9113210 16
<b>20</b>	911323 20	911324 20	911325 20	911326 20	911328 20	9113210 20
<b>25</b>		911324 25	911325 25	911326 25	911328 25	9113210 25
<b>30</b>		911324 30	911325 30	911326 30	911328 30	9113210 30
<b>40</b>		911324 40	911325 40	911326 40	911328 40	9113210 40
<b>50</b>			911325 50	911326 50	911328 50	9113210 50
<b>60</b>			911325 60	911326 60	911328 60	9113210 60
	100	100	100	100	100	100
<b>dk</b>	6	8	10	12	16	20
<b>k</b>	1,75	2,4	2,95	3,45	4,6	5,5
<b>Antrieb</b>	SW2 PIN	SW2,5 PIN	SW3 PIN	SW4 PIN	SW5 PIN	SW6 PIN



## ARTIKEL 9118 SI-WINKELSCHLÜSSEL FÜR ISK-PIN-ANTRIEB

ITEM 9118  
SECURITY WRENCHES FOR HEXAGON SOCKET DRIVE + PIN

Doppelseitig verwendbar  
On both sides usable

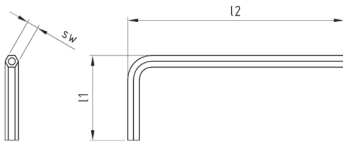

Antrieb Drive size	l1 l1	l2 l2	Artikelnummer Item Number	
SW1/8"	22,5	63,5	911818	1
SW2	20,5	58,5	91182	1
SW2,5	20,5	58,5	911825	1
SW3	23	66	91183	1
SW4	29	74	91184	1
SW5	33	85	91185	1
SW6	38	96	91186	1



## ARTIKEL 9119 SI-BITS FÜR ISK-PIN ANTRIEB

ITEM 9119  
SECURITY BITS FOR HEXAGON SOCKET DRIVE + PIN

1/4" Sechskant Aufnahme  
1/4" hexagon

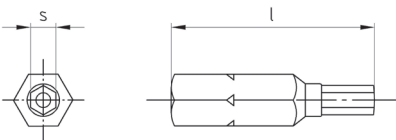

Antrieb Drive size	l l	Artikelnummer Item Number	
SW1/8"	25	911918	1
SW2	25	91192	1
SW2,5	25	911925	1
SW3	25	91193	1
SW4	25	91194	1
SW5	25	91195	1
SW6	25	91196	1

# INNENSECHSRUND + PIN

## ARTIKEL 9120 - 9129

---

*SIX LOBE DRIVE + PIN*  
*ITEM 9120 - 9129*



### PRODUKTVORTEILE:

- Sicherheitsaufnahme PIN
- nur mit speziellen Bit zu verarbeiten

### PRODUCT BENEFITS:

- Security admission PIN
- to process only with special bit



## ARTIKEL 9120 A2 FLACHRUNDKOPF-SI SCHRAUBEN, ISR + PIN, BLECHGEWINDE

ITEM 9120 A2  
BUTTON HEAD SECURITY SCREWS SIX LOBE DRIVE + PIN

**MERKMALE:**

- Blechgewinde
- ISR + PIN
- Flachrundkopf

**FEATURES:**

- Sheet thread
- ISR + PIN
- Button head

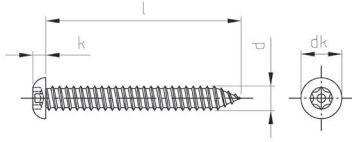

d	3,5	4,2	4,8	5,5	6,3
<b>l/mm</b>	Art. Nr. / Item no.	Art. Nr. / Item no.	Art. Nr. / Item no.	Art. Nr. / Item no.	Art. Nr. / Item no.
<b>13</b>	9120235 13	9120242 13	9120248 13	9120255 13	9120263 13
<b>19</b>	9120235 19	9120242 19	9120248 19	9120255 19	9120263 19
<b>25</b>	9120235 25	9120242 25	9120248 25	9120255 25	9120263 25
<b>32</b>	9120235 32	9120242 32	9120248 32	9120255 32	9120263 32
<b>38</b>	9120235 38	9120242 38	9120248 38	9120255 38	9120263 38
<b>50</b>			9120248 50	9120255 50	9120263 50
<b>63</b>				9120255 63	
<b>75</b>				9120255 75	
<b>☞</b>	100	100	100	100	100
<b>dk</b>	5,7	7,6	9,5	9,9	10,5
<b>k</b>	1,65	2,2	2,75	2,9	3,3
<b>Antrieb</b>	TX10 PIN	TX15 PIN	TX25 PIN	TX27 PIN	TX27 PIN



## ARTIKEL 9121 A2-80 FLACHRUNDKOPF-SI SCHRAUBEN, ISR + PIN, METRISCHES GEWINDE

ITEM 9121 A2-80  
BUTTON HEAD SECURITY SCREWS SIX LOBE DRIVE + PIN

**MERKMALE:**

- Metrisches Gewinde
- ISR + PIN
- Flachrundkopf

**FEATURES:**

- Metric thread
- ISR + PIN
- Button head

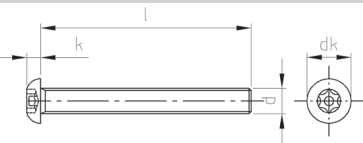

d	M 6
<b>l/mm</b>	Art. Nr. / Item no.
<b>20</b>	91212806 20
<b>☞</b>	100
<b>dk</b>	10,5
<b>k</b>	3,3
<b>Antrieb</b>	TX30 PIN



# ARTIKEL 9121 A2 FLACHRUNDKOPF-SI SCHRAUBEN, ISR + PIN, METRISCHES GEWINDE

ITEM 9121 A2  
BUTTON HEAD SECURITY SCREWS SIX LOBE DRIVE + PIN

**MERKMALE:**

- Metrisches Gewinde
- ISR + PIN
- Flachrundkopf

**FEATURES:**

- Metric thread
- ISR + PIN
- Button head

d	M 3	M 4	M 5	M 6	M 8	M 10
<b>l/mm</b>	Art. Nr. / Item no.	Art. Nr. / Item no.	Art. Nr. / Item no.	Art. Nr. / Item no.	Art. Nr. / Item no.	Art. Nr. / Item no.
6	912123 6	912124 6				
8	912123 8	912124 8	912125 8			
10	912123 10	912124 10	912125 10	912126 10	912128 10	
12	912123 12	912124 12	912125 12	912126 12	912128 12	
14				912126 14		
16	912123 16	912124 16	912125 16	912126 16	912128 16	9121210 16
18				912126 18		
20	912123 20	912124 20	912125 20	912126 20	912128 20	9121210 20
22				912126 22		
25		912124 25	912125 25	912126 25	912128 25	9121210 25
30		912124 30	912125 30	912126 30	912128 30	9121210 30
35		912124 35		912126 35		
40		912124 40	912125 40	912126 40	912128 40	9121210 40
45				912126 45		
50		912124 50	912125 50	912126 50	912128 50	9121210 50
55				912126 55		
60			912125 60	912126 60	912128 60	9121210 60
65					912128 65	9121210 65
70					912128 70	9121210 70



<b>l</b>	100	100	100	100	100	100
<b>dk</b>	5,7	7,6	9,5	10,5	14	17,5
<b>k</b>	1,65	2,2	2,75	3,3	4,4	5,5
<b>Antrieb</b>	TX10 PIN	TX20 PIN	TX25 PIN	TX30 PIN	TX40 PIN	TX45 PIN



# ARTIKEL 9122 A2

## SENKKOPF-SI SCHRAUBEN, ISR + PIN, BLECHGEWINDE

ITEM 9122 A2  
CSK HEAD SECURITY SCREWS WITH SIX LOBE DRIVE + PIN



### MERKMALE:

- Blechgewinde
- ISR + PIN
- Senkkopf

### FEATURES:

- Sheet thread
- ISR + PIN
- Countersunk head

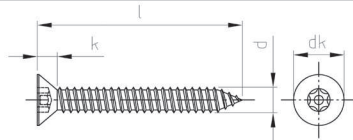

d	3,5	4,2	4,8	5,5	6,3
<b>l/mm</b>	Art. Nr. / Item no.	Art. Nr. / Item no.	Art. Nr. / Item no.	Art. Nr. / Item no.	Art. Nr. / Item no.
<b>13</b>	9122235 13	9122242 13	9122248 13	9122255 13	
<b>16</b>	9122235 16	9122242 16	9122248 16	9122255 16	9122263 16
<b>19</b>	9122235 19	9122242 19	9122248 19	9122255 19	9122263 19
<b>25</b>	9122235 25	9122242 25	9122248 25	9122255 25	9122263 25
<b>32</b>	9122235 32	9122242 32	9122248 32	9122255 32	9122263 32
<b>38</b>	9122235 38	9122242 38	9122248 38	9122255 38	9122263 38
<b>50</b>			9122248 50	9122255 50	9122263 50
<b>63</b>				9122255 63	
<b>75</b>				9122255 75	

<b>l</b>	100	100	100	100	100
<b>dk</b>	6,8	8,1	9,5	10,8	12,4
<b>k</b>	2,15	2,6	3,15	3,55	4
<b>Antrieb</b>	TX15 PIN	TX20 PIN	TX25 PIN	TX27 PIN	TX30 PIN



## ARTIKEL 9123 A2 SENKKOPF-SI SCHRAUBEN, ISR + PIN, METRISCHES GEWINDE

ITEM 9123 A2  
CSK HEAD SECURITY SCREWS WITH SIX LOBE DRIVE + PIN

### MERKMALE:

- Metrisches Gewinde
- ISR + PIN
- Senkkopf

### FEATURES:

- Metric thread
- ISR + PIN
- Countersunk head

d	M 3	M 3,5	M 4	M 5	M 6
<b>l/mm</b>	Art. Nr. / Item no.	Art. Nr. / Item no.	Art. Nr. / Item no.	Art. Nr. / Item no.	Art. Nr. / Item no.
6	912323 6		912324 6		
8	912323 8		912324 8	912325 8	
10	912323 10		912324 10	912325 10	912326 10
12	912323 12	9123235 12	912324 12	912325 12	912326 12
16	912323 16		912324 16	912325 16	912326 16
20	912323 20		912324 20	912325 20	912326 20
25			912324 25	912325 25	912326 25
30			912324 30	912325 30	912326 30
40			912324 40	912325 40	912326 40
50			912324 50	912325 50	912326 50
60				912325 60	912326 60
70				912325 70	912326 70
80				912325 80	

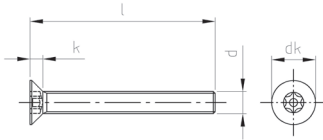

	100	100	100	100	100
<b>dk</b>	6	7	8	10	12
<b>k</b>	1,75	2	2,4	2,95	3,45
<b>Antrieb</b>	TX10 PIN	TX15 PIN	TX20 PIN	TX25 PIN	TX30 PIN



## ARTIKEL 9128 SI-WINKELSCHLÜSSEL FÜR ISR-PIN-ANTRIEB

ITEM 9128  
SECURITY WRENCHES FOR SIX LOBE DRIVE + PIN

### MERKMALE:

- von beiden Seiten verwendbar
- Winkelschlüssel für passende ISR-PIN Antriebe

### FEATURES:

- from both sides usable
- wrenches for appropriate ISR-PIN drives

l1 l1	l2 l2	Antrieb Drive size	Artikelnummer Item Number	
19	59	TX10	912810	1
20	65	TX15	912815	1
20,5	75,5	TX20	912820	1
22	87	TX25	912825	1
22,5	97,5	TX27	912827	1
25,5	105,5	TX30	912830	1
30	111	TX40	912840	1
33	119	TX45	912845	1

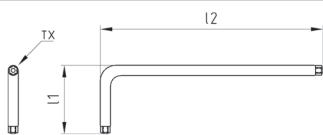

# ARTIKEL 9129

## SI-BITS FÜR ISR-PIN-ANTRIEB



ITEM 9129  
SECURITY BITS FOR SIX LOBE DRIVE + PIN

**MERKMALE:**

1/4" Sechskant Aufnahme

**FEATURES:**

1/4" hex

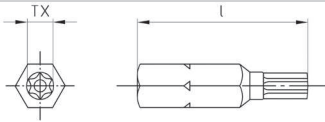

Antrieb Drive size	l l	Artikelnummer Item Number	
TX10	25	912910	1
TX15	25	912915	1
TX20	25	912920	1
TX25	25	912925	1
TX27	25	912927	1
TX30	25	912930	1
TX40	25	912940	1
TX45	25	912945	1

# EINWEG-ANTRIEB

## ARTIKEL 9130 - 9139

---

*ONE WAY DRIVE*  
*ITEM 9130 - 9139*



#### PRODUKTVORTEILE:

- Sicherheitsaufnahme Einweg
- nur mit speziellen Bit zu verarbeiten

#### PRODUCT BENEFITS:

- *Security admission oneway*
- *to process only with special bit*



## ARTIKEL 9130 A2 HALBRUNDKOPF-SI SCHRAUBEN, EINWEG-ANTRIEB, BLECHGEWINDE

ITEM 9130 A2  
PAN HEAD SECURITY SCREWS WITH ONEWAY DRIVE

### MERKMALE:

- Blechgewinde
- Einwegantrieb
- Halbrundkopf

### FEATURES:

- Sheet thread
- Oneway drive
- Pan head

d	2,9	3,5	4,2	4,8	5,5	6,3
<b>l/mm</b>	Art. Nr. / Item no.	Art. Nr. / Item no.	Art. Nr. / Item no.	Art. Nr. / Item no.	Art. Nr. / Item no.	Art. Nr. / Item no.
9,5	9130229 95					
13	9130229 13	9130235 13	9130242 13	9130248 13	9130255 13	9130263 13
16	9130229 16	9130235 16	9130242 16	9130248 16	9130255 16	9130263 16
19	9130229 19	9130235 19	9130242 19	9130248 19	9130255 19	9130263 19
25		9130235 25	9130242 25	9130248 25	9130255 25	9130263 25
32		9130235 32	9130242 32	9130248 32	9130255 32	9130263 32
38			9130242 38	9130248 38	9130255 38	9130263 38
50				9130248 50	9130255 50	9130263 50
63					9130255 63	9130263 63
75						9130263 75
	100	100	100	100	100	100
<b>dk</b>	5,4	6,5	7,3	9,1	10,4	12
<b>k</b>	2,2	2,6	3	3,5	3,9	4,4

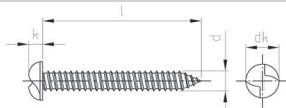

## ARTIKEL 9131 A2 HALBRUNDKOPF-SI SCHRAUBEN, EIN- WEG-ANTRIEB, METRISCHES GEWINDE

ITEM 9131 A2  
PAN HEAD SECURITY SCREWS WITH ONEWAY DRIVE

### MERKMALE:

- Metrisches Gewinde
- Einwegantrieb
- Halbrundkopf

### FEATURES:

- Metric thread
- Oneway drive
- Pan head

d	M 4	M 5	M 6	M 8
<b>l/mm</b>	Art. Nr. / Item no.	Art. Nr. / Item no.	Art. Nr. / Item no.	Art. Nr. / Item no.
8	913124 8	913125 8		
10	913124 10	913125 10	913126 10	913128 10
12	913124 12	913125 12	913126 12	913128 12
16	913124 16	913125 16	913126 16	913128 16
20	913124 20	913125 20	913126 20	913128 20
25	913124 25	913125 25	913126 25	913128 25
30	913124 30	913125 30	913126 30	913128 30
35	913124 35	913125 35	913126 35	913128 35
40	913124 40	913125 40	913126 40	913128 40
45	913124 45	913125 45	913126 45	913128 45
50	913124 50	913125 50	913126 50	913128 50
60		913125 60	913126 60	913128 60
70		913125 70	913126 70	913128 70
	100	100	100	100
<b>dk</b>	7,5	9,17	12	13
<b>k</b>	2	3,5	4,4	4,8





## ARTIKEL 9132 A2 LINSENKOPF-SI SCHRAUBEN, EINWEG-ANTRIEB, BLECHGEWINDE

ITEM 9132 A2  
RAISED CSK HEAD SECURITY SCREWS WITH ONEWAY DRIVE

**MERKMALE:**

- Metrisches Gewinde
- Einwegantrieb
- Halbrundkopf

**FEATURES:**

- Metric thread
- Oneway drive
- Pan head

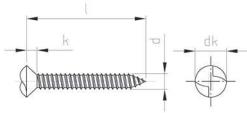

d	4,2	4,8
l/mm	Art. Nr. / Item no.	Art. Nr. / Item no.
13	9132242 13	9132248 13
16	9132242 16	9132248 16
19	9132242 19	9132248 19
25	9132242 25	9132248 25
32	9132242 32	9132248 32
38	9132242 38	9132248 38
	100	100
dk	8,4	9,8
k	3,9	4,5



## ARTIKEL 9139 SI SCHRAUBENLÖSER FÜR EINWEGSCHRAUBEN

ITEM 9139  
ONE WAY SCREW REMOVER

**MERKMALE:**

- Scharfe Kanten durch Hartmetallstücke gewährleistet eine lösende Einwegschraube

**FEATURES:**

- Sharp edges of hard metal pieces ensures a disposable screw-solving

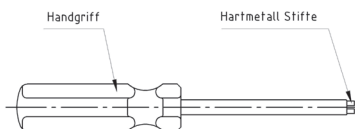

d	Artikelnummer	
d	Item Number	
4	91394	1
5	91395	1
6	91396	1

# MIT STOPFEN ARTIKEL 9140 - 9156

---

*WITH PLUG  
ITEM 9140 - 9156*



#### PRODUKTVORTEILE:

- Schraube + Stopfen in einer VPE
- unlösbare Befestigung

#### PRODUCT BENEFITS:

- *Screw + plug in a pack*
- *Insoluble connection*



## ARTIKEL 9140 A2 FLACHRUNDKOPF-SI SCHRAUBEN, ISK MIT STOPFEN, METRISCHES GEWINDE

ITEM 9140 A2  
HEXAGON SOCKET BUTTON HEAD SCREWS WITH PLUG

### MERKMALE:

- Metrisches Gewinde
- ISK mit Stopfen
- Flachrundkopf

### FEATURES:

- Metric screws
- ISK with plug
- Button head

d	M 6	M 8	M 10	M 12
<b>l/mm</b>	Art. Nr. / Item no.	Art. Nr. / Item no.	Art. Nr. / Item no.	Art. Nr. / Item no.
10	914026 10	914028 10		
12	914026 12	914028 12		
16	914026 16	914028 16	9140210 16	
20	914026 20	914028 20	9140210 20	9140212 20
25	914026 25	914028 25	9140210 25	9140212 25
30	914026 30	914028 30	9140210 30	9140212 30
35	914026 35	914028 35	9140210 35	9140212 35
40	914026 40	914028 40	9140210 40	9140212 40
45	914026 45	914028 45	9140210 45	9140212 45
50	914026 50	914028 50	9140210 50	9140212 50
60	914026 60	914028 60	9140210 60	9140212 60

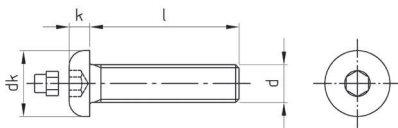

<b>l</b>	100	100	100	100
<b>dk</b>	10,5	14	17,5	21
<b>k</b>	3,3	4,4	5,5	6,6
<b>Antrieb</b>	SW4	SW5	SW6	SW7



## ARTIKEL 9141 A2 SENKKOPF-SI SCHRAUBEN, ISK MIT STOPFEN, METRISCHES GEWINDE

ITEM 9141 A2  
HEXAGON SOCKET CSK HEAD SECURITY SCREWS WITH PLUG

### MERKMALE:

- Metrisches Gewinde
- ISK mit Stopfen
- Senkkopf

### FEATURES:

- Metric screws
- ISK with plug
- Countersunk head

d	M 6	M 8	M 10	M 12
<b>l/mm</b>	Art. Nr. / Item no.	Art. Nr. / Item no.	Art. Nr. / Item no.	Art. Nr. / Item no.
10	914126 10	914128 10		
12	914126 12	914128 12		
16	914126 16	914128 16	9141210 16	
20	914126 20	914128 20	9141210 20	9141212 20
25	914126 25	914128 25	9141210 25	9141212 25
30	914126 30	914128 30	9141210 30	9141212 30
35	914126 35	914128 35	9141210 35	9141212 35
40	914126 40	914128 40	9141210 40	9141212 40
45	914126 45	914128 45	9141210 45	9141212 45
50	914126 50	914128 50	9141210 50	9141212 50
60	914126 60	914128 60	9141210 60	9141212 60
70		914128 70		

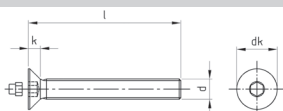

<b>l</b>	100	100	100	100
<b>dk</b>	12	16	20	24
<b>k</b>	3,45	4,6	5,5	6,5





## ARTIKEL 9145 A1 SI STOPFEN FÜR ISK ANTRIEB

ITEM 9145 A1  
SECURITY PLUGS FOR HEXAGON SOCKET DRIVE

### MERKMALE:

- Stopfen für alle herkömmliche Sechskant-Schrauben verwendbar
- unlösbare Verbindung

### FEATURES:

- Plugs for all conventional hex-screws used
- Insoluble connection

d d	Antrieb Drive size	Artikelnummer Item Number	
6	SW4	914514	100
8	SW5	914515	100
10	SW6	914516	100
12	SW8	914518	100

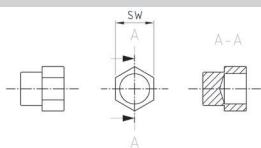

## ARTIKEL 9156 ZINK SI STERNE FÜR ISR ANTRIEB

ITEM 9156 ZINC  
SECURITY STARS FOR SIX LOBE DRIVE

### MERKMALE:

- Zink-Druckguss
- unlösbare Verbindung

### FEATURES:

- Die-cast zinc
- Insoluble connection

Antrieb Drive size	a a	b b	h h	Artikelnummer Item Number	
TX10	2,75	1,9	1,1	9156010	100
TX15	3,25	2,3	1,8	9156015	100
TX20	3,82	2,7	1,6	9156020	100
TX25	4,42	3,11	2,45	9156025	100
TX30	5,5	3,9	2,2	9156030	100
TX40	6,65	4,7	3,4	9156040	100

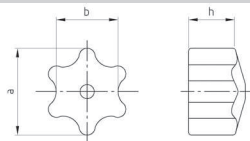

# ABREISSMUTTER & SCHRAUBE ARTIKEL 9150 & 9155

---

*INVOLABLE NUTS & SHEAR SCREWS WITH BRAKING POINT  
ITEM 9150 & 9155*

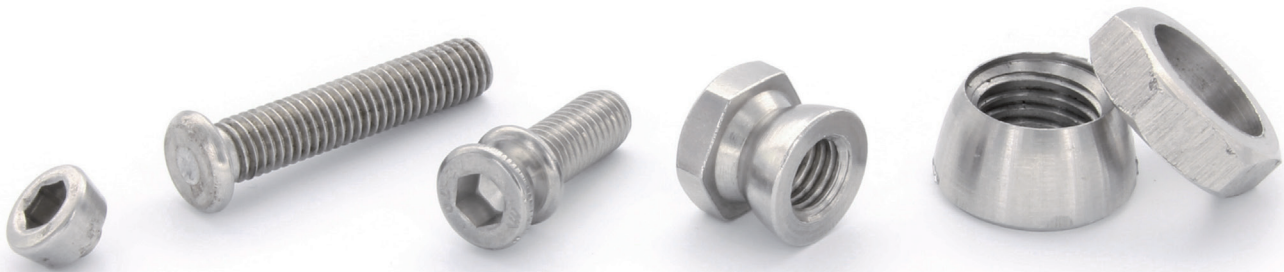

#### PRODUKTVORTEILE:

- Hoher Diebstahlschutz
- Unlösbare Befestigung
- Kein Sonderwerkzeug erforderlich

#### PRODUCT BENEFITS:

- *High theft protection*
- *Insoluble connection*
- *No special tools*

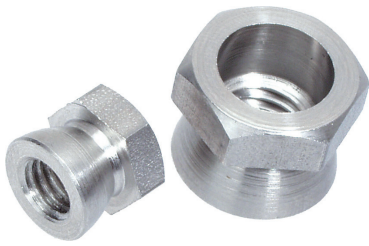

## ARTIKEL 9150 A2 ABREISSMUTTERN

ITEM 9150 A2  
INVOLABLE NUTS

### MERKMALE:

- Metrisches Gewinde
- ISK-Antrieb

### FEATURES:

- Metric thread
- ISK drive

d d	h h	m m	d2 d2	Abreiß[Nm] Pulloff[Nm]	Antrieb Drive size	Artikelnummer Item Number	
6	9,5	3,5	9,8	7-13	SW10	915026	100
8	12	4	12,8	13-25	SW13	915028	500
10	15	5	16,8	30-40	SW17	9150210	100
12	16	5,5	18,8	35-45	SW19	9150212	100
16	20,5	7	23,8	45-60	SW24	9150216	100
20	25	4	29,8	65-80	SW30	9150220	100

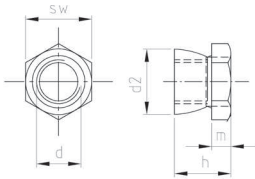

## ARTIKEL 9155 A2 ABREISSSCHRAUBEN MIT ABREISSDREHMOMENT 18 - 25 NM

ITEM 9155 A2  
SHEAR SCREWS WITH BREAKING POINT 18 - 25 NM

### MERKMALE:

- Metrisches Gewinde
- ISK-Antrieb

### FEATURES:

- Metric thread
- ISK drive

d d	l l	k1 k1	k2 k2	dk dk	Abreiß[Nm] Pulloff[Nm]	Antrieb Drive size	Artikelnummer Item Number	
8	20	8,6	1	13	18-25	SW6	915528 20	100
	25	8,6	1	13	18-25	SW6	915528 25	100
	30	8,6	1	13	18-25	SW6	915528 30	100
	35	8,6	1	13	18-25	SW6	915528 35	100
	40	8,6	1	13	18-25	SW6	915528 40	100
	45	8,6	1	13	18-25	SW6	915528 45	100
	50	8,6	1	13	18-25	SW6	915528 50	100

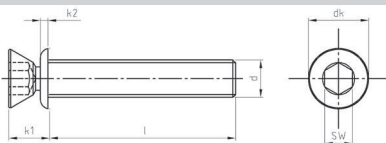

# SICHERHEITSSCHRAUBEN BEI S + P

ARTIKEL- NUMMER	BEZEICHNUNG II	KOPFFORMEN					GEWINDE			AUFNAHME			MATERIAL					
		SENKKOPF	LINSENKOPF	RUNDKOPF	HALBRUNDKOPF	FLACHRUNDKOPF	ZYLINDERKOPF	BLECHGEWINDE	METRISCHES GEWINDE	INNENSECHSRUND + PIN	INNENSECHSKANT + PIN	ZWEILOCHANTRIEB	EINWEG-ANTRIEB	INNENSECHSKANT	A2	A1	ZINK	CV STAHL
9100	ZYLINDERKOPF-SI SCHRAUBEN, ZWEILOCHANTRIEB, BLECHGEWINDE					X	X				X			X				
9101	ZYLINDERKOPF-SI SCHRAUBEN, ZWEI- LOCHANTRIEB, METRISCHES GEWINDE					X		X			X			X				
9102	SENKKOPF-SI SCHRAUBEN, ZWEILOCHANTRIEB, BLECHGEWINDE	X					X				X			X				
9103	SENKKOPF-SI SCHRAUBEN, ZWEILOCHANTRIEB, METRISCHES GEWINDE	X						X			X			X				
9104	LISEKO-SI SCHRAUBEN, ZWEILOCHANTRIEB, BLECHGEWINDE		X				X				X			X				
9105	RUNDKOPF-SI SCHRAUBEN, ZWEILOCHANTRIEB, BLECHGEWINDE			X			X				X			X				
9109	SI-BITS FÜR ZWEILOCHANTRIEB										X							X
9110	FLACHRUNDKOPF -SI SCHRAUBEN, ISK+PIN, BLECHGEWINDE					X	X				X			X				
9111	FLACHRUNDKOPF-SI SCHRAUBEN, ISK+PIN, METRISCHES GEWINDE					X		X			X			X				
9112	SENKKOPF-SI SCHRAUBEN, ISK+PIN, BLECHGEWINDE	X					X				X			X				
9113	SENKKOPF-SI SCHRAUBEN, ISK+PIN, METRISCHES GEWINDE	X						X			X			X				
9118	SI-WINKELSCHLÜSSEL FÜR ISK-PIN- ANTRIEB										X							X
9119	SI-BITS FÜR ISK-PIN ANTRIEB										X							X
9120	FLACHRUNDKOPF-SI SCHRAUBEN, ISR+PIN, BLECHGEWINDE					X	X	X						X				
9121	FLACHRUNDKOPF-SI SCHRAUBEN, ISR+PIN, METRISCHES GEWINDE					X		X	X					X				
9122	SENKKOPF-SI SCHRAUBEN, ISR+PIN, BLECHGEWINDE	X					X	X						X				
9123	SENKKOPF-SI SCHRAUBEN, ISR+PIN, METRISCHES GEWINDE	X						X	X					X				
9128	SI-WINKELSCHLÜSSEL FÜR ISR-PIN- ANTRIEB								X									X
9129	SI-BITS FÜR ISR-PIN-ANTRIEB								X									X
9130	HALBRUNDKOPF-SI SCHRAUBEN, EINWEG-ANTRIEB, BLECHGEWINDE				X		X					X		X				
9131	HALBRUNDKOPF-SI SCHRAUBEN, EIN- WEG-ANTRIEB, METRISCHES GEWINDE				X			X				X		X				
9132	LINSENKOPF-SI SCHRAUBEN, EINWEG-ANTRIEB, BLECHGEWINDE		X				X					X		X				
9139	SI SCHRAUBENLÖSER FÜR EINWEGSCHRAUBEN											X						X
9140	FLACHRUNDKOPF-SI SCHRAUBEN, ISK MIT STOPFEN, METRISCHES GEWINDE					X		X					X	X				
9141	SENKKOPF-SI SCHRAUBEN, ISK MIT STOPFEN, METRISCHES GEWINDE	X						X					X	X				
9145	EINSCHLAGSTOPFEN FÜR INNENS- ECHSKANTANTRIEB															X		
9150	ABREISSMUTTERN							X						X				
9155	ABREISSSCHRAUBEN MIT ABREISS- DEHMOMENT							X					X	X				
9156	SI STERNE FÜR ISR ANTRIEB																	X

# SECURITY SCREWS AT S + P

ITEM NUMBER	TITLE II	HEAD SHAPE					THREAD			DRIVE				MATERIAL				
		COUNTERSUNK HEAD	RAISED COUNTERSUNK	ROUNDHEAD	PANHEAD	TRUSS HEAD	CHEESE HEAD	SHEET THREAD	METRIC THREAD	SIX LOBE DRIVE + PIN	HEX SOCKET + PIN	TWO HOLE DRIVE	ONEWAY DRIVE	HEX SOCKET	A2	A1	ZINC	CV STEEL
9100	CHEESE HEAD SECURITY SCREWS WITH TWO HOLE DRIVE					X	X				X			X				
9101	CHEESE HEAD SECURITY SCREWS WITH TWO HOLE DRIVE					X		X			X			X				
9102	COUNTERSUNK HEAD SECURITY SCREWS, TWO HOLE DRIVE	X					X				X			X				
9103	COUNTERSUNK HEAD SECURITY SCREWS, TWO HOLE DRIVE	X						X			X			X				
9104	RAISED CSK HEAD SECURITY SCREWS, TWO HOLE DRIVE		X				X				X			X				
9105	PAN HEAD SECURITY SCREWS WITH TWO HOLE DRIVE			X			X				X			X				
9109	SECURITY BITS FOR TWO HOLE DRIVE										X							X
9110	BUTTON HEAD SECURITY SCREWS HEX SOCKET DRIVE + PIN					X	X			X				X				
9111	BUTTON HEAD SECURITY SCREWS HEX SOCKET DRIVE + PIN					X		X		X				X				
9112	CSK HEAD SECURITY SCREWS, HEX SOCKET DRIVE + PIN	X					X			X				X				
9113	CSK HEAD SECURITY SCREWS, HEX SOCKET DRIVE + PIN	X						X		X				X				
9118	SECURITY WRENCHES FOR HEXAGON SOCKET DRIVE + PIN										X							X
9119	SECURITY BITS FOR HEXAGON SOCKET DRIVE + PIN										X							X
9120	BUTTON HEAD SECURITY SCREWS, SIX LOBE DRIVE + PIN					X	X		X					X				
9121	BUTTON HEAD SECURITY SCREWS, SIX LOBE DRIVE + PIN					X		X	X					X				
9122	CSK HEAD SECURITY SCREWS WITH SIX LOBE DRIVE + PIN	X					X		X					X				
9123	CSK HEAD SECURITY SCREWS WITH SIX LOBE DRIVE + PIN	X						X	X					X				
9128	SECURITY WRENCHES FOR SIX LOBE DRIVE + PIN										X							X
9129	SECURITY BITS FOR SIX LOBE DRIVE + PIN										X							X
9130	PAN HEAD SECURITY SCREWS WITH ONEWAY DRIVE					X	X					X		X				
9131	PAN HEAD SECURITY SCREWS WITH ONEWAY DRIVE					X		X				X		X				
9132	RAISED CSK HEAD SECURITY SCREWS WITH ONEWAY DRIVE		X				X					X		X				
9139	ONE WAY SCREW REMOVER											X						X
9140	HEXAGON SOCKET BUTTON HEAD SCREWS WITH PLUG					X		X					X	X				
9141	HEXAGON SOCKET CSK HEAD SECURITY SCREWS WITH PLUG	X						X					X	X				
9145	DRIVE-IN PLUGS FOR HEXAGON SOCKET DRIVE															X		
9150	SHEAR NUTS WITH BREAKING POINT							X						X				
9155	SHEAR SCREWS WITH BREAKING POINT							X					X	X				
9156	DRIVE-IN STARS FOR SIX LOBE DRIVE																	X



# General terms of supply and payment for Schäfer + Peters GmbH

(hereinafter also named „S+P“, Öhringen, Version dated September 2011

## I. Scope of application

1. The following sales terms and conditions apply to all the contracts concluded between the purchaser and S + P for the supply of goods, insofar as the purchaser is a company, a legal entity under public law or a special fund under public law. Orders will be fulfilled on the basis of the following terms and conditions only. The offer, the acceptance of the offer, the order confirmation and the sale of any products are subject to the present conditions. We do not recognise any contrary or different terms of the purchaser, unless we have accepted explicitly that they are valid. The following terms and conditions also apply if we carry out the order without reservation in the awareness of the purchaser's contrary or different terms.
2. All the agreements between the purchaser and S + P regarding performance of the purchase contracts up to the point when the contract in question was concluded have been recorded in writing in the contracts. This does not affect the effectiveness of any agreements concluded separately.
3. Where S + P and the purchaser have concluded a framework agreement, these General Terms and Conditions shall apply to this framework agreement and to the individual supply or purchase contract.
4. The General Terms and Conditions shall also apply to all future business dealings even if they are not explicitly agreed again.

## II. Offer and conclusion of contract

1. We can choose to accept an order from the purchaser which qualifies as a legally binding offer to conclude a purchase contract within two weeks, either by sending confirmation of the order or by providing the services or goods ordered without reservation.
2. Our offers are subject to change without notice and non-binding, unless we have explicitly designated them as binding. Information about our goods (including, but not limited to data, dimensions, performance and consumption data and the descriptions in the product information sheets or advertising material etc) are only approximate; they are not a guarantee of quality, unless the guarantee has been given explicitly and in writing.
3. We retain title, copyright and other proprietary rights to all illustrations, calculations, drawings and other documents. The purchaser may only pass these on to third parties with our written permission, irrespective of whether we have designated them as confidential.

## III. Payment conditions

1. Our prices are ex works Öhringen, and do not include packaging, duty, insurance and any other fees applying in individual cases, if not specified otherwise. Statutory VAT is not included in our prices. We will state the statutory amount separately on the invoice on the day the invoice is issued.
2. If not otherwise agreed, invoices shall be due for payment with no discount within 30 days of the date of the invoice and delivery. Payments within 10 days of the invoice date shall attract a discount of 2% unless the purchaser is in default of other payments to us. A payment shall not be considered complete until the amount is available to us. Payments by cheque shall not be considered complete until the cheque has been honoured.
3. If the purchaser does not pay within the specified period, he or she will be in default without a further demand for payment having been issued. Should the purchaser be in default of payment, the statutory late payment interest rate for companies shall be applied to the purchase price. Rights shall be reserved to make further claims. If the purchaser fails to make payment following another demand, we shall be entitled to accelerate immediately all the purchaser's debts, including, but not limited to, deferred payments or payments to be made in instalments, and to refuse to supply any more goods.
4. The purchaser shall only be authorised to offset payments and/or retain the goods if the counterclaims are derived from the same contractual relationship. If the delivery is based on an outline agreement or other long-term contractual relationship, the possibility to offset payments applies only to debts from the actual legal relationship from which the principle claim and counterclaim result. If the counterclaim is not based on the same contractual relationship, the purchaser can only offset the payment if the counterclaims have been legally established, are acknowledged by us or are uncontested.
5. If S + P have permitted the purchaser to pay by instalments, the total amount remaining will be due for payment if the buyer delays payment of one instalment for longer than 8 days.
6. Price changes shall be permissible if more than 4 months pass between conclusion of the contract and the agreed delivery date and the price change is due to a current increase in costs for which we are not responsible. Costs are deemed to have increased if wages, material costs or sales costs have risen before the delivery. The same applies if duty is increased or a duty is introduced or our suppliers increase their prices or there are exchange rate fluctuations. In these instances, S + P are justified in increasing the price commensurately with the rise in costs.

## IV. Delivery and performance time, liability if delivery delayed.

1. Delivery times or periods which have not been explicitly agreed as binding are non-binding statements only. They are only approximate and describe the time and date when delivery can be expected. Any different agreements regarding a binding delivery date and time must be made explicitly and in writing. The delivery time will start when the purchaser has properly completed the actions incumbent on him or her to help bring about the delivery.
2. If we do not receive deliveries or services from our suppliers or subcontractors through no fault of our own despite having made the appropriate provisions, or do not receive them at the appropriate time or there are instances of force majeure, we will inform our customers in good time in writing. In this event, we are entitled to postpone the delivery or the service for the duration of the impediment, or to withdraw partially or in full from the contract on account of the unfulfilled part of the contract, provided we have fulfilled our obligation to provide information as described above and have not accepted the risks associated with procurement or manufacture. Instances of force majeure are strikes, lock-out, intervention by authorities, lack of power or raw materials, transport bottlenecks through no fault of ours, operational impediments through no fault of ours such as fire, water, damage to machinery and all other impediments which from an objective point of view are not our fault. If the delivery or the service is delayed by more than a month, then both we and the customer – to the exclusion of all claims for damages – shall be entitled to withdraw from the contract where the quantity affected by the delivery problems is concerned. The customer shall be entitled to withdraw fully from the contract if it is unreasonable to expect him or her to accept a part delivery.
3. In any case we will not be deemed to be delaying delivery until a subsequent reasonable period set by the customer has expired, unless the transaction includes delivery by a fixed date within the meaning of Section 286 para. 2 no. 4 German Civil Code (BGB) or Section 376 German Commercial Code.
4. Claims for damages arising from delayed delivery shall be excluded, provided they are not the result of intentional or gross negligence on our part or that of our agents or of a culpable infringement of substantive contractual obligations. Those contractual obligations are substantive which protect the customer's legal position which the content and purpose of the contract must provide; also substantive are those contractual obligations the fulfillment of which is only made possible by the correct performance of the contract and on which as a general rule, the contractual partner relies and may rely.
- Exclusion of liability for ordinary negligence shall not apply to damages resulting from injury to life, body or health or from the infringement of substantive contractual obligations or which affect warranties.
- However, where a substantive contractual obligation has been infringed as the result of ordinary negligence, we shall only be liable for average damages that are foreseeable, typical and immediate, given the type of contract concluded.
5. Should we be responsible for delaying the delivery, the purchaser shall be able to claim flatrate compensation amounting to 0.5% of the value of the delivery for every full week of the delay, up to a maximum of 5% of the value of the delivery, unless we show that he or she has suffered less or no damage.
6. We shall be entitled to make part deliveries or deliver only some services at any time if the customer can be reasonably expected to accept this.
7. If the purchaser delays accepting the goods, we shall be entitled to request compensation for the losses this causes and for any extra expenditure. The same applies if the purchaser culpably fails to fulfil his or her duty to cooperate.

## V. Place of performance, transfer of risk, despatch and packing

1. Where no other agreement has been made, the place of performance shall be our registered company offices in Öhringen.
2. Where no other agreement has been made, the risk of accidental damage or loss of the goods shall pass to the purchaser as follows: as soon as the goods are not despatched from our warehouse in Öhringen, at the time when the goods are made available to the first transport person, or, if the purchaser is delaying acceptance, at the time at which we offer the transfer in such a way as to constitute a delivery, provided the goods are despatched from our warehouse in Öhringen at the time at which we inform the customer the goods are available for collection. Loading and despatch shall not be insured and shall be at the risk of the purchaser.
3. We shall endeavour to take account of the purchaser's wishes and interests regarding the method and route of despatch; any extra costs arising as a result – even when carriage paid has been agreed – will be charged to the purchaser.
4. We do not take back any transport or other packaging in accordance with the packaging directive, with the exception of pallets. The purchaser must dispose of the packaging which becomes his or her property at his or her own cost.
5. If the despatch is delayed at the wish or due to the fault of the purchaser, we shall store the goods at the cost and risk of the purchaser. In this case, notification that we are ready to dispatch shall be equivalent to the despatch.
6. We shall insure the delivery through a transport insurance company if the purchaser wishes and at his or her cost. Explicit instructions in writing from the purchaser are required to effect this.

## VI. Warranty / limits of liability / compensation for wasted expenditure

1. Warranty claims by the purchaser are valid only if the purchaser has correctly fulfilled the statutory obligations in examining the goods and making a complaint. We must be notified in writing of detectable defects within a week of receipt of the goods. If this is not done, the goods shall be deemed approved. S + P must be notified of latent defects as soon as they have been found.
2. If the defect in the goods is our fault, we are initially obliged to rectify the defect unless legislation entitles us to refuse rectification. The purchaser's rights to withdraw from the contract or reduce the selling price are excluded. The purchaser must allow us a reasonable period to rectify the defect. The purchaser can choose to have the defect rectified through elimination (correction) or through delivery of new goods. Where the defect is eliminated, we shall bear the necessary expenses, provided these are not increased because the object of the contract is at a location different from the place of performance.
- If the rectification to which the purchaser is entitled fails or it is unreasonable to expect the purchaser to accept it, or the rectification is refused under the provisions of Section 439 para. 3 German Civil Code, or, the interests of both parties having been weighed up,

the circumstances are such that require immediate claim for compensation for damages or withdrawal, the purchaser can request that the purchase price be reduced or announce withdrawal from the contract.

- The purchaser can only assert claims for compensation for damages due to the defect under the following conditions if the rectification has failed. The right of the purchaser to assert further claims for damages under the following conditions shall not be affected.
3. Claims in accordance with Section 478 German Civil Code (Recourse of the entrepreneur) asserted by the purchaser against S + P shall exist only in so far as the purchaser has not entered into any agreements with his or her customer which contain provisions which extend beyond statutory warranty claims (see point 4). A claim is excluded if the purchaser has not correctly fulfilled the statutory obligations to examine the goods and to make a complaint in respect of a defect.
4. The obligation stated in item VI, point 3 is excluded if the defect is based on advertising statements or other contractual agreements which did not originate with us or if the purchaser has given the end consumer a special warranty. The obligation is similarly excluded if the purchaser him/herself was under no obligation towards the end consumer under the statutory regulations governing the exercise of warranty rights or did not give notice of this defect in respect of a claim made upon it. This also applies if the purchaser has given the end consumer warranties which extend beyond the statutory requirements.
5. Claims for damages arising from defects in the title or quality shall be excluded provided they are not the result of intentional or gross negligence on our part or that of our agents or a culpable infringement of substantive contractual obligations. Those contractual obligations are substantive which protect the customer's legal position which the content and purpose of the contract must provide; also substantive are those contractual obligations the fulfillment of which is only made possible by the correct performance of the contract and on which as a general rule, the contractual partner relies and may rely.
- Exclusion of liability for ordinary negligence shall not apply to damages resulting from injury to life, body or health or from the infringement of substantive contractual obligations or from warranties or claims based on product liability legislation.
- However, where a substantive contractual obligation has been infringed as the result of ordinary negligence, we shall only be liable for average damages that are foreseeable, typical and immediate, given the type of contract concluded.
6. Claims for compensation for wasted expenditure in accordance with Section 284 German Civil Code shall be waived if in accordance with the above, a claim for compensation for damage in the place of effective performance has been excluded in the contract.

## VII. Liability

Claims for damages resulting from infringement of a non-contractual obligation (tortious liability) or from culpability on or previous to concluding the contract (culpa in contrahendo) and for other legal reasons, including, but not limited to infringement of the general obligation to be considerate (section 241 para. 2 German Civil Code) or other contractual obligations (Section 280 Section 1 German Civil Code) provided these are not already claims against warranty shall be excluded, provided they are not the result of intentional or gross negligence on our part or that of our agents or of the culpable infringement of substantive contractual obligations.

This includes but is not limited to, our liability where a substantive contractual obligation has been infringed as the result of ordinary negligence, for average damages that given the type of contract concluded are foreseeable, typical and immediate.

Exclusion of liability for ordinary negligence shall not apply to damages resulting from injury to life, body or health or the infringement of substantive contractual obligations or from warranties or claims based on product liability legislation.

## VIII. Statute of limitations

Claims of the purchaser for warranty and compensation for damages (items IV, VI, VII) shall fall under the statute of limitations one year after the goods have been delivered. This shall not apply where we are liable for damages which result from injury to life, body or health and the infringement of substantive contractual obligations, are based on fraudulently concealed defects, or affect warranties and claims under product liability legislation. The shortening of the period of the statute of limitations shall not apply in the event of recourse of the entrepreneur (Sections 478 and 479 of the German Civil Code) or the object purchased is a building or has been as a building in accordance with customary use and caused its defectiveness (Section 438 para. 1 no. 2 German Civil Code).

## IX. Reservation of title

1. The goods supplied by us shall remain our property until all the existing claims or claims arising in the future which are due to us for any legal reason from the ongoing business relationship and/or the actual purchase contract with the purchaser are fulfilled. If the purchaser is in breach of the contract, in default of payment, for example, we shall be entitled after setting an appropriate interval to take back the goods subject to retention of title. Our taking back the goods subject to retention of title shall represent withdrawal from the contract. Our seizing the goods subject to retention of title shall constitute withdrawal from the contract. We shall be entitled to resell the goods subject to retention of title after taking them back. After subtracting an appropriate amount for the costs of reselling, the proceeds of the resale will be used to offset the monies owed to us by the purchaser.
2. The purchaser must handle the goods subject to retention carefully and insure them at their as-new value against damage from fire, water and theft. The purchaser must carry out any maintenance and service work required at his or her cost. The purchaser shall also be obliged, at S + P's request, to inform us at any time about the condition of the goods and to tell us where they are stored.
3. The purchaser shall be entitled to sell and/or use the goods subject to retention of title in a proper business transaction as long as he or she is not in default of payment. Pledging or assignment as collateral is not permitted. The purchaser shall assign all claims arising from a sale or other legal basis (insurance, non-permitted activity) of the goods subject to retention of title (including all current account balance claims) now for reasons of safety; we hereby accept the assignment. We authorise the purchaser to call in the debts assigned for the purchaser's account in his or her own name. The authorisation to call in the debts can be revoked at any time if the purchaser does not fulfil his or her payment obligations correctly. The purchaser is not authorised to assign this debt for the purposes of calling in the debt via factoring, unless at the same time, the factor is obliged to give us immediate consideration in the amount still owed to us by the purchaser. The purchaser shall furthermore be obliged to inform us immediately of any seizure of the goods or other impairment by third parties.
4. The goods subject to retention will in any case be processed or converted for us by the purchaser. If the goods subject to retention of title are processed with objects which do not belong to us, we shall acquire joint ownership of the new object to the value of the goods subject to retention (final invoice amount, including VAT) relative to the other processed objects at the time of processing. If the goods subject to retention of title are inseparably combined with objects which do not belong to us, we shall acquire joint ownership of the new object to the value of the goods subject to retention (final invoice amount, including the VAT) relative to the other combined objects at the time of combining. If the purchaser's object is to be deemed a primary object as the result of the combining, and if the purchaser and we agree that the purchaser shall transfer to us proportionate joint ownership in this object, we herewith accept the transfer. The purchaser shall keep our exclusive or joint ownership thus created in safe custody. The same applies to the new object created from the processing or conversion as for the goods subject to retention of title, with the restriction however that the purchaser assigns claims from third parties to us in the amount of joint ownership we acquired as stated above.
5. If third parties access the goods subject to retention, including but not limited to seizures, the purchaser shall make them aware of our title and inform us immediately so that we can assert our right to title. If the third party is unable to reimburse us for any legal or non-legal costs arising in this respect, the purchaser shall be liable for them.
6. We shall be obliged to release the collateral owed to us in so far as the realisable value of our collateral exceeds the claims to be collateralised by more than 10%; we shall be able to choose which collateral to release.

## X. Place of performance, choice of forum, applicable legislation

1. The place of performance and choice of forum for deliveries and payments (including complaints regarding cheques or bills) and for all disputes arising between us and the purchaser from the purchase contracts concluded between us and him or her shall be Öhringen. However we shall be entitled to file a complaint against the purchaser at his or her residence or registered business address.
2. The legal relationship between us and our customers or between us and third parties shall be governed exclusively by the legislation of the Federal Republic of Germany.

## XI. Miscellaneous

1. In the event that one or more of the provisions in this agreement is or becomes partly invalid or incomplete, or is excluded by a special agreement, this shall not affect the validity of the remaining provisions.
2. We would like to point out that we hold our customers' data as part of our mutual business relationships in accordance with the Federal Data Protection Act.

## Schäfer + Peters GmbH



**Schäfer + Peters GmbH**

Zeilbaumweg 32  
DE-74613 Öhringen

Tel. +49 (0) 7941 6094-0  
Fax +49 (0) 7941 6094-700

[info@schaefer-peters.com](mailto:info@schaefer-peters.com)  
[www.schaefer-peters.com](http://www.schaefer-peters.com)

